

ASCENT™ SPX

Instruction Manual • Manuel d'utilisation

Model: RVOF1200

Ascent SPx RTF

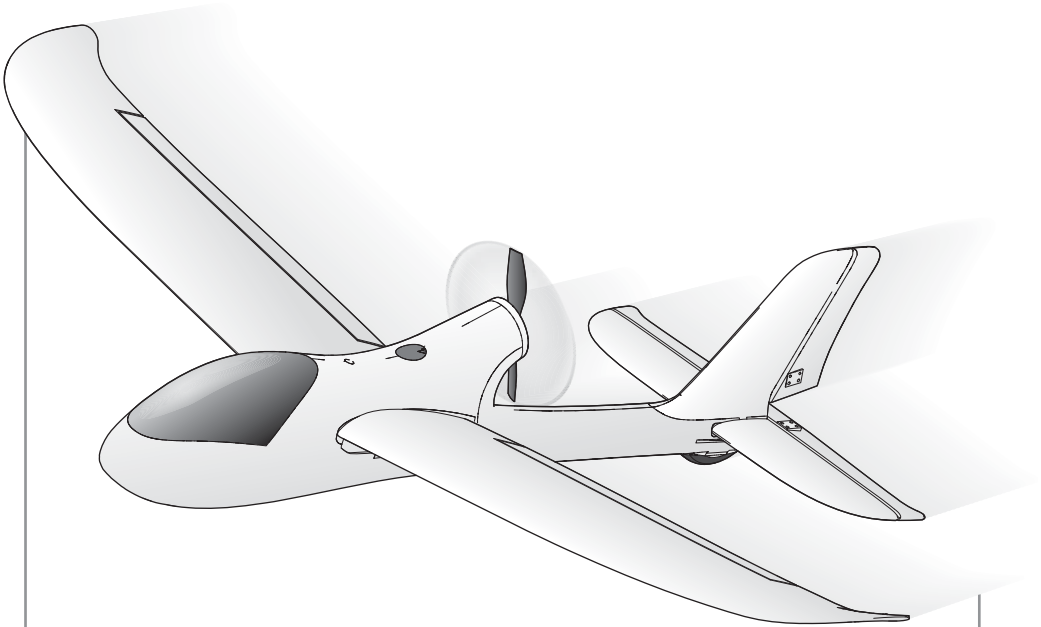

REVOLUTION®



READY-TO-FLY

NOTICE

All instructions, warranties and other collateral documents are subject to change at the sole discretion of Horizon Hobby, LLC. For up-to-date product literature, visit www.horizonhobby.com and click on the support tab for this product.

Meaning of Special Language:

The following terms are used throughout the product literature to indicate various levels of potential harm when operating this product:

NOTICE: Procedures, which if not properly followed, create a possibility of physical property damage AND little or no possibility of injury.

CAUTION: Procedures, which if not properly followed, create the probability of physical property damage AND a possibility of serious injury.

WARNING: Procedures, which if not properly followed, create the probability of property damage, collateral damage, and serious injury OR create a high probability of superficial injury.



WARNING: Read the ENTIRE instruction manual to become familiar with the features of the product before operating. Failure to operate the product correctly can result in damage to the product, personal property and cause serious injury.

This is a sophisticated hobby product. It must be operated with caution and common sense and requires some basic mechanical ability. Failure to operate this product in a safe and responsible manner could result in injury or damage to the product or other property. This product is not intended for use by children without direct adult supervision. Do not use with incompatible components or alter this product in any way outside of the instructions provided by Horizon Hobby, LLC. This manual contains instructions for safety, operation and maintenance. It is essential to read and follow all the instructions and warnings in the manual, prior to assembly, setup or use, in order to operate correctly and avoid damage or serious injury.

Age Recommendation: Not for children under 14 years. This is not a toy.

Safety Precautions and Warnings

- Always keep a safe distance in all directions around your model to avoid collisions or injury. This model is controlled by a radio signal subject to interference from many sources outside your control. Interference can cause momentary loss of control.
- Always operate your model in open spaces away from full-size vehicles, traffic and people.
- Always carefully follow the directions and warnings for this and any optional support equipment (chargers, rechargeable battery packs, etc.).
- Always keep all chemicals, small parts and anything electrical out of the reach of children.
- Always avoid water exposure to all equipment not specifically designed and protected for this purpose. Moisture causes damage to electronics.
- Never place any portion of the model in your mouth as it could cause serious injury or even death.
- Never operate your model with low transmitter batteries.
- Always keep aircraft in sight and under control.
- Always use fully charged batteries.
- Always keep the transmitter powered on while aircraft is powered.
- Always remove batteries before disassembly.
- Always keep moving parts clean.
- Always keep parts dry.
- Always let parts cool after use before touching.
- Always remove batteries after use.
- Always ensure failsafe is properly set before flying.
- Never operate aircraft with damaged wiring.
- Never touch moving parts.

Included in the Box

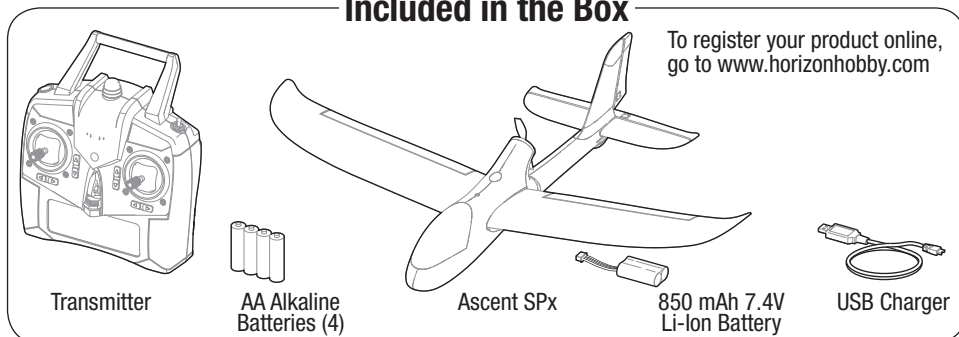

Specifications

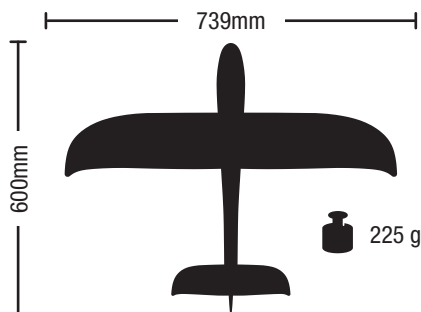

Preflight Checklist

✓	
	1. Find a safe and open area.
	2. Charge flight battery.
	3. Install flight battery in aircraft.
	4. Perform Control Test.
	5. Plan flight for flying field conditions.
	6. Set a flight timer for 10 minutes.
	7. Have fun!

Flying Tips

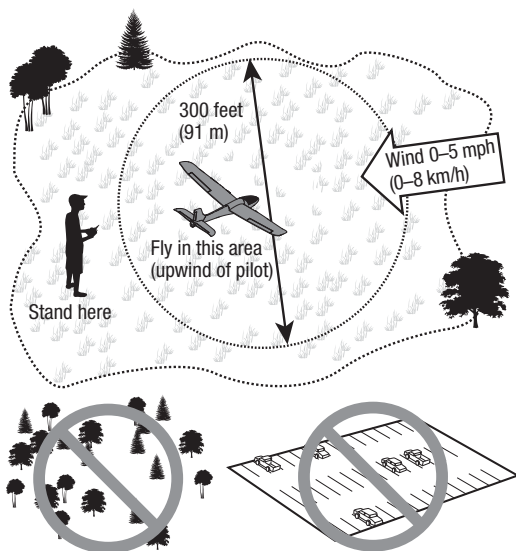

- Consult local laws and ordinances before choosing a location to fly your aircraft.
- Fly your aircraft outside in no greater than light winds.
- For indoor flight, fly the aircraft inside in a large gymnasium
- Keep your aircraft in plain sight and up wind. Do not exceed the 300 foot (91 m) radio range. If the connection is lost, the motors will power off and the aircraft will descend. Leave your transmitter powered on and move closer to your aircraft to regain control.
- Always avoid flying near houses, trees, wires and buildings.
- Always avoid flying in areas where there are many people, such as busy parks, schoolyards or soccer fields.

Transmitter

- A: Throttle
- B: Throttle Trim
- C: Rudder Trim
- D: Handle
- E: Antenna
- F: Speaker
- G: Dual Rate Switch
- H: LED
- I: Elevator/Rudder
- J: Aileron Trim*
- K: Elevator Trim
- L: Power Switch

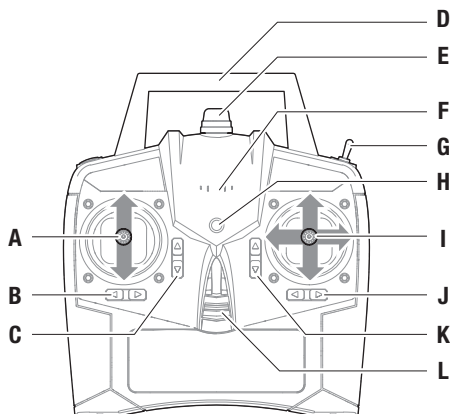

Transmitter Batteries Installation

Remove the battery cover, install the four included AA batteries (noting proper polarity) and reinstall the battery cover.

CAUTION: If using rechargeable batteries, charge only rechargeable batteries. Charging non-rechargeable batteries may cause the batteries to burst, resulting in injury to persons and/or damage to property.

CAUTION: Risk of explosion if battery is replaced by an incorrect type. Dispose of used batteries according to national regulations.

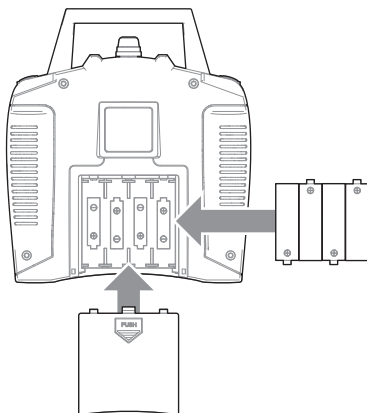

Low Battery Alarm

When the transmitter battery voltage drops too low, an alarm sounds and the LED flashes. The batteries must be replaced immediately. If this happens while flying, land your aircraft as soon and as safely as possible.

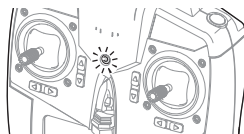

Charging Warnings

The USB charger has been designed to safely charge the included Li-Ion battery.

CAUTION: All instructions and warnings must be followed exactly. Mishandling of Lithium batteries can result in a fire, personal injury and/or property damage.

- **NEVER LEAVE CHARGING BATTERIES UNATTENDED**
- **NEVER CHARGE BATTERIES OVERNIGHT**
- By handling, charging or using the included Li-Ion battery, you assume all risks associated with lithium batteries.
- If at any time the battery begins to balloon or swell, discontinue use immediately. If charging or discharging, discontinue and disconnect. Continuing to use, charge or discharge a battery that is ballooning or swelling can result in fire.
- Always store the battery at room temperature in a dry area for best results.
- Always transport or temporarily store the battery in a temperature range of 40–120° F. Do not store the battery or model in a car or direct sunlight. If stored in a hot car, the battery can be damaged or even catch fire.
- Always charge batteries away from flammable materials.
- Always inspect the battery before charging.
- Always disconnect the battery after charging, and let the charger cool between charges.
- Always constantly monitor the temperature of the battery pack while charging.
- **ONLY USE A CHARGER SPECIFICALLY DESIGNED TO CHARGE LI-ION BATTERIES.** Failure to charge the battery with a compatible charger may cause a fire resulting in personal injury and/or property damage.
- Never discharge Li-Ion cells to below 3V under load.
- Never cover warning labels with hook and loop strips.
- Never charge batteries outside recommended levels.
- Never charge damaged batteries.
- Never attempt to dismantle or alter the charger.
- Never allow minors to charge battery packs.
- Never charge batteries in extremely hot or cold places (recommended between 40–120° F or 5–49° C) or place in direct sunlight.

Charging the Flight Battery

1. Connect the Li-Ion battery to the included USB charger.
2. Connect the USB charger to a phone USB charge adapter (not included) or into any powered USB port.
3. The LED on the charger will glow solid red while charging and will turn off when charging is complete.

Always charge the aircraft battery before flying.

CAUTION: Do not store the Li-Ion battery in the charger. Doing so could over-discharge the Li-Ion battery.

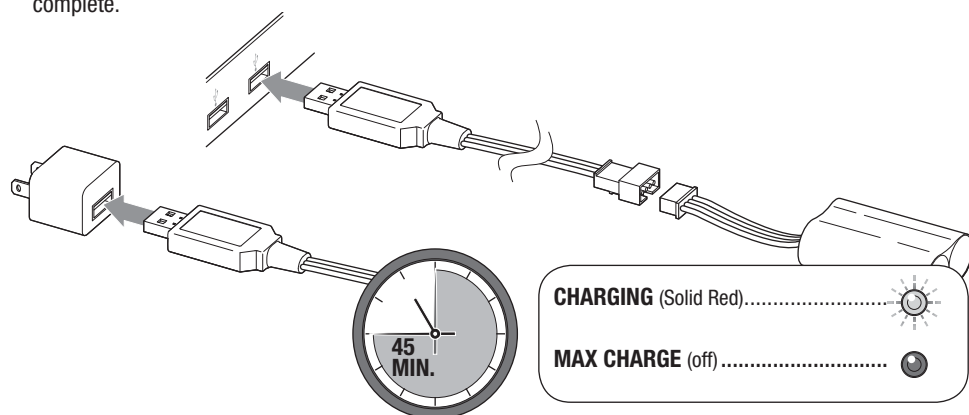

Wing Installation

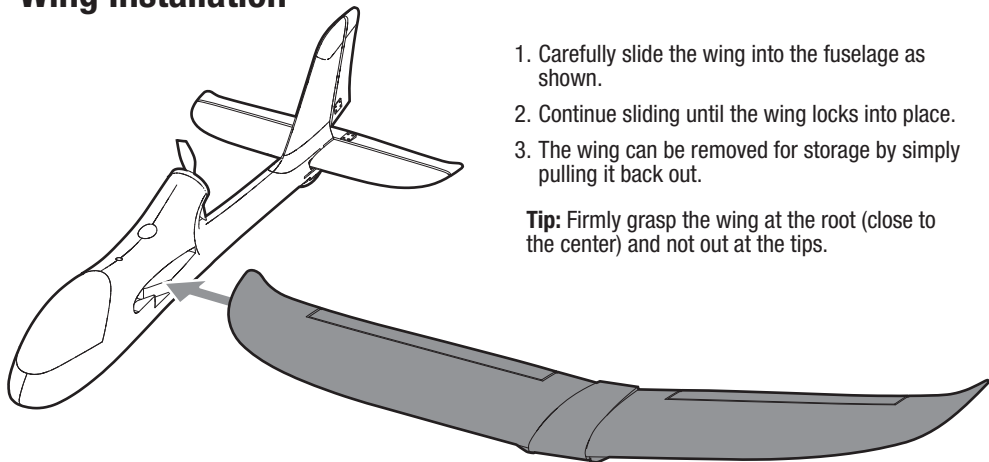

1. Carefully slide the wing into the fuselage as shown.
2. Continue sliding until the wing locks into place.
3. The wing can be removed for storage by simply pulling it back out.

Tip: Firmly grasp the wing at the root (close to the center) and not out at the tips.

Installing the Flight Battery

1. Make sure the throttle is in the off position (0%) and then turn on the transmitter.
2. Remove the canopy from the aircraft.
3. Plug in the flight battery.
4. Install the flight battery into the aircraft as shown and close the canopy.

⚠ CAUTION: Always disconnect the flight battery from the aircraft when not flying to avoid over-discharging the battery. Batteries discharged to a voltage lower than the lowest approved voltage may become damaged, resulting in loss of performance and potential fire when batteries are charged.

⚠ CAUTION: Keep away from the propellers.

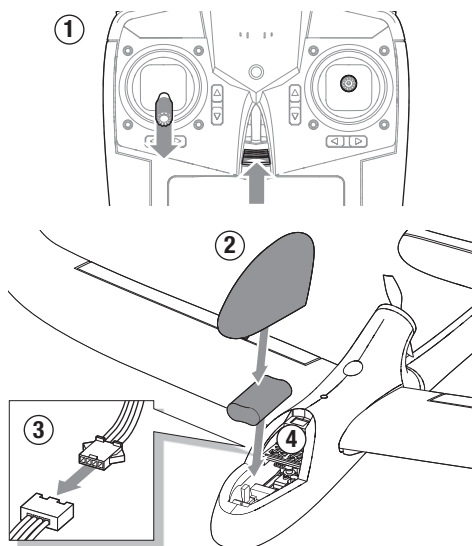





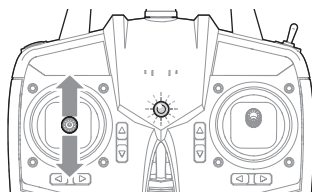





Arming the Aircraft

1. Move the throttle stick from power off (0%) to full throttle (100%) and back to power off.
2. The red LED will change from flashing to solid when arming is complete.

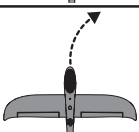

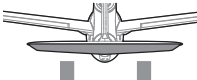
Control Test

1. Turn the aircraft and transmitter on.
2. Arm the aircraft.
3. Move the sticks on the transmitter to ensure the aircraft responds as shown.
4. Note the corresponding flight direction to control surface movement.
5. If surfaces do not move as expected, DO NOT fly. See the troubleshooting section in the back of this manual.

Transmitter	Control Surface	Flight Direction
 Turn left	 Rudder left	
 Turn Right	 Rudder Right	
 Nose Down	 Elevator Down	
 Nose Up	 Elevator Up	

Binding

If your aircraft does not respond to the transmitter when the batteries in the aircraft and transmitter are fully charged, bind your aircraft and transmitter by using the instructions below.

1. Turn off the aircraft by first disconnecting the flight battery from the aircraft and then powering off the transmitter.
2. Make sure your transmitter's controls are neutral, and the throttle is in the off position (0%).
3. Power on the transmitter. The red LED will start flashing indicating the transmitter is in Bind mode.
4. Connect the flight battery to the aircraft.
5. Hold the transmitter more than 24 inches (60 cm) away from the aircraft. Keep away from large metal objects, wireless sources and other transmitters.
6. Move the throttle stick from power off (0%) to full throttle (100%) and back to power off. The red LED will change from flashing to solid when the Bind is complete.
7. Once the Bind is complete you will have control of the aircraft.

Control Centering

After assembly, confirm that the control surfaces are centered. If the control surfaces are not centered, mechanically center the control surfaces by adjusting the linkages.

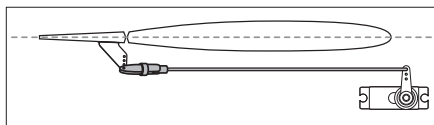

If adjustment is required, turn the clevis on the linkage to change the length of the linkage between the servo arm and the control horn.

1. Slide the rubber tube from the clevis.
2. Carefully spread the clevis apart to remove it from the control horn.
3. Turn the clevis clockwise or counter clockwise to lengthen or shorten the linkage.
4. Carefully spread the clevis apart and insert the pin in the correct hole in the control horn. See Control Horn Settings below.
5. Slide the rubber tube back on the clevis to lock it closed.

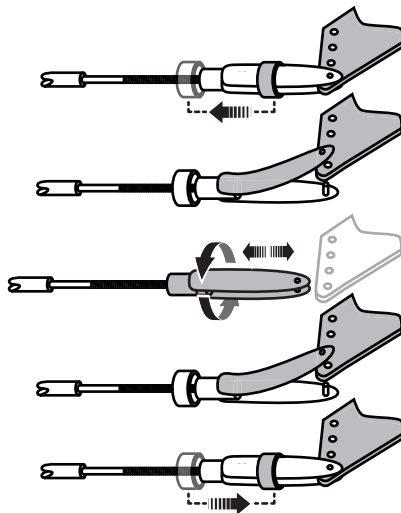

Control Horn Settings

The table to the right shows the factory settings for the control horns. Fly the aircraft at factory settings.



CAUTION: When these are incorrectly connected for the pilot's skill level, unexpected aircraft response to controls can result. This can cause damage to the aircraft and personal injury.

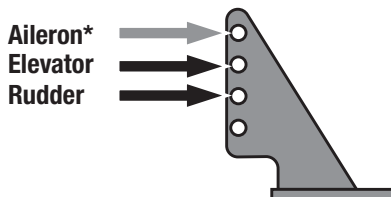

*Used with optional aileron wing set.

Dual Rates

Dual rates allow for a quick, on the fly adjustment to the aircraft's responsiveness to control inputs. Low rates = less response and high rates = more.

Tip: The Dual Rate switch supports high and low rate functions for both elevator and rudder control surfaces.

Tip: For the first flight, fly the model in low rate.

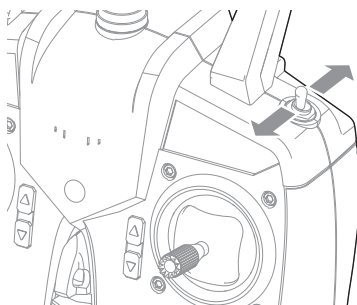

Flying

Taking Off

Get help to hand launch your aircraft so you can concentrate on flying. If you must hand launch the aircraft alone, hold the model in your dominant hand and the transmitter in your other hand.

1. Face into the wind and apply full (100%) throttle.
2. Hold the plane horizontal and launch straight and level into the wind.
3. The aircraft will climb under full throttle (100%).
4. Reduce to 50% throttle once the plane is at a safe altitude (50-75 feet) to level out.
5. Once at a safe altitude, use the elevator to control altitude and turn with the rudder.

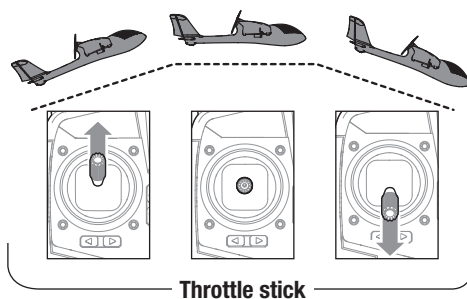
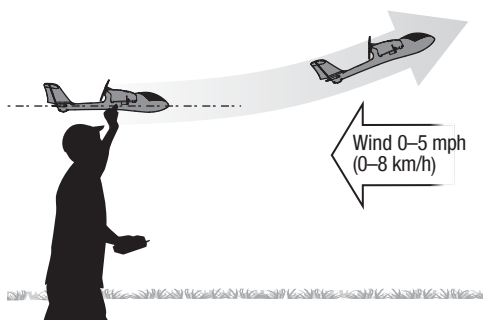

Turning

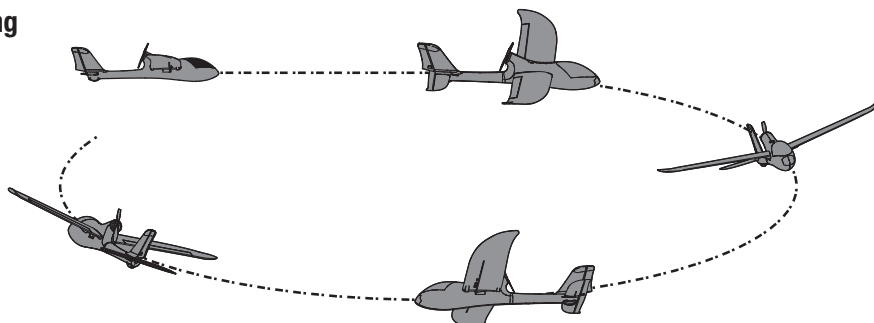

To turn the aircraft, make small controlled movements with the right stick.

For a right hand turn:

1. Move the right stick slowly to the right.
2. Once the turn begins, add in a little throttle to maintain altitude.
3. Use gentle stick movements to continue the turn to the right.
 - If the turn is too wide, add more right stick.
 - If the turn is too tight, add less right stick.
4. To stop the turn, gently release the right stick and lower the throttle to maintain level flight.

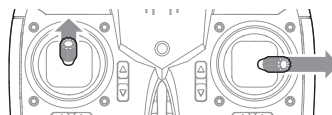

Tip: Try to finish the turn at the same altitude it was started from.





For a left hand turn, follow steps above, moving the stick to the left.

In Flight Trim

If the aircraft's nose drifts left, right, up or down while the sticks are at neutral (centered) press the trim buttons as shown in the chart to correct the drift.

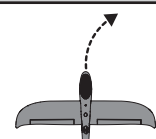
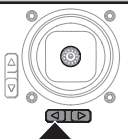
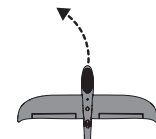
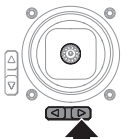
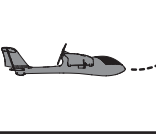
If the aircraft nose still drifts after all trim has been used, land and manually trim the aircraft.

See Control Centering section earlier in this manual.

Direction of Drift	Button to Correct
	
	
	
	

When you notice any reduction of power or 10 minutes have elapsed, immediately land the aircraft and recharge the battery.

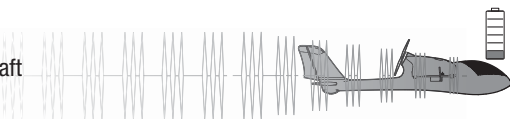

Landing

1. Fly downwind and reduce the throttle to 25% to begin the descent.
2. Begin turning towards the runway, heading into the wind.
3. Reduce the throttle to 0% and glide onto the runway.
 - If you are going to land short of the runway, add a little throttle to extend the glide.
 - If you are going too fast to land, go around and try again.

CAUTION: Never catch a flying aircraft in your hands. Doing so could cause personal injury and damage to the aircraft.

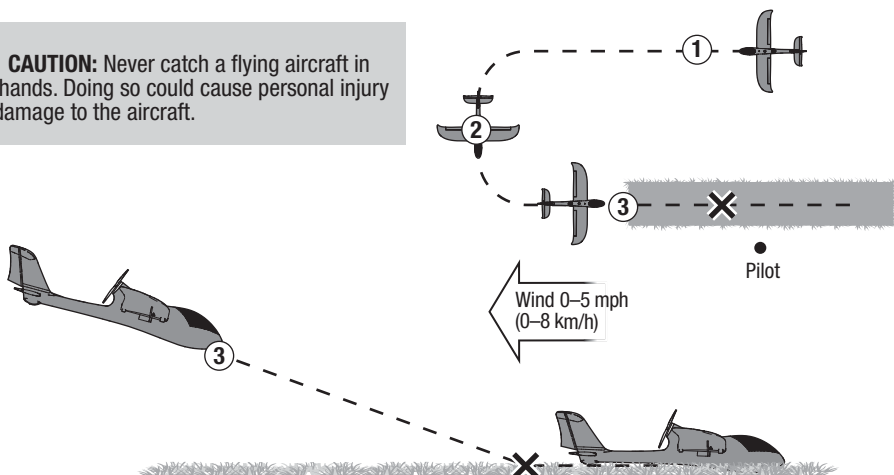

Post flight Checklist

✓	
1.	Lower throttle to 0%
2.	Disconnect and remove the flight battery
3.	Power off the transmitter
4.	Fully charge the flight battery

NOTICE: When you are finished flying, never leave the aircraft in direct sunlight or in a hot, enclosed area such as a car. Doing so can damage the foam.

✓	
5.	After charging is complete, remove the battery and store in a safe place
6.	Inspect airframe and make any repairs
7.	Store in the original product box

NOTICE: Always disconnect the battery from the aircraft before powering off the transmitter or injury and damage may result.

Repairs

NOTICE: Crash damage is not covered under the warranty.

Repair the aircraft using CA (cyanoacrylate adhesive) or clear tape. When parts are not repairable, see the Replacement Parts List for ordering by item number.

For a listing of all replacement and optional parts, refer to the list at the end of this manual.

NOTICE: Using CA accelerant on your aircraft can damage paint. DO NOT handle the aircraft until the accelerant fully dries.

NOTICE: When you are finished flying, never leave the aircraft in direct sunlight or in a hot, enclosed area such as a car. Doing so can damage the foam.

Propeller Service

1. Remove the propeller (A) from the motor shaft (B).
2. Carefully align the new propeller on the motor shaft and firmly press into place.

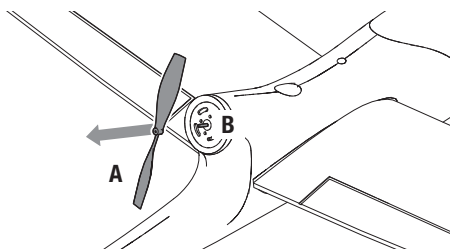

Tail Replacement

1. Disconnect the elevator linkage.
2. Remove one screw from the bottom of the aircraft and slide the horizontal tail out of the rear of the fuselage.
3. Slide the new tail into position and secure it with one screw.
4. Connect the control linkages.

See the Control Centering section to properly align the control surface.

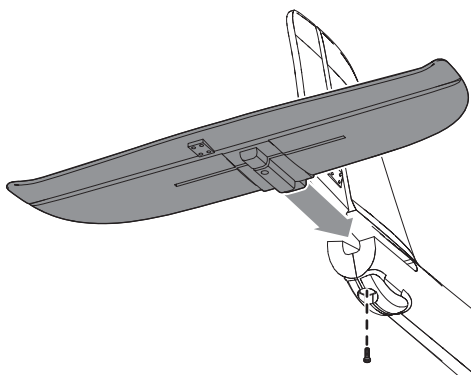

Optional Aileron Wing Installation

1. Using double sided tape or glue (epoxy or hot glue) install the aileron servo into the fuselage.

Important: Do not use thin CA near the servo.

2. Attach the aileron servo plug into the aileron slot on the receiver.
3. Attach the pushrods to the servo arm.
4. Attach the servo arm to the servo. Insert a screw driver down through the small hole in the top of the fuselage to tighten the servo horn screw.
5. Carefully slide the wing into the fuselage.
6. Attach the pushrods to the aileron control horns.
7. See Control Centering earlier in this manual.

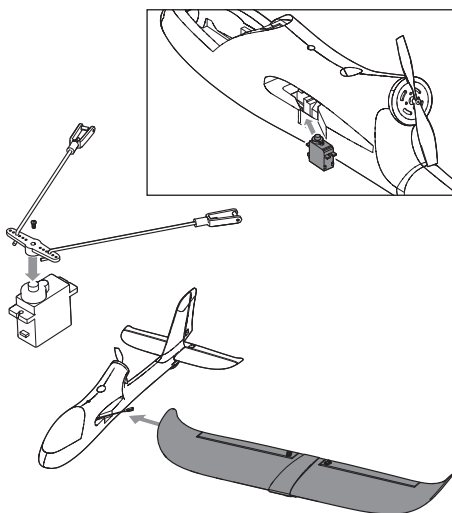

Optional Aileron Transmitter Programming

To use the aileron wing, the transmitter needs to be converted from 3CH (throttle, elevator, rudder) to 4CH (throttle, rudder, elevator, aileron). Follow the steps listed below. Once complete, the transmitter will retain these settings. To go back to 3CH, simply repeat this process.

Perform the following steps with the aircraft powered off.

1. Lower the throttle to the off position (0%).
2. Hold in the left rudder trim while powering on the transmitter. After 3 seconds the transmitter will beep and the LED will glow solid.
3. Release the rudder trim; programming is complete.

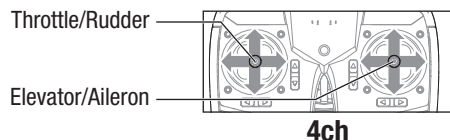
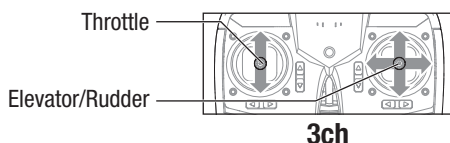
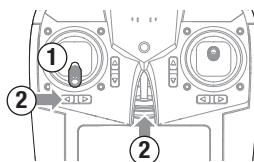

Troubleshooting Guide

Problem	Possible Cause	Solution
Aircraft does not respond to the transmitter	No connection	Follow Binding Instructions. Follow “Installing the Flight Battery” instructions. Replace or recharge batteries
	Transmitter too near the aircraft or both are too near large metal objects, wireless sources or another transmitter during battery connection or binding	Move to another location, with the transmitter more than 24 inches (60 cm) from the aircraft and attempt battery connection or binding again
	Low or no power	Replace or recharge batteries and correctly connect the aircraft battery
Poor aircraft response to the transmitter	Poor radio connection	Replace or recharge batteries
	Poor control adjustment or damage to the aircraft	Adjust steering by using left or right trim buttons or land immediately and adjust, repair or replace parts
Aircraft turns in one direction	Poor control adjustment or damage to the aircraft	Adjust steering by using the left or right trim buttons or land immediately and adjust, repair or replace parts
	Wind is too gusty or strong	Fly on a calmer day
Aircraft rises steeply at half throttle	Poor control adjustment or damage to the aircraft	Use less throttle to fly without climbing
	Elevator is trimmed for a climb	Trim elevator down slightly
	Aircraft battery is incorrectly installed	Install aircraft battery fully back
	Wind is too gusty or strong	Fly on a calmer day
Aircraft will not climb	Poor control adjustment or damage to the aircraft	Increase throttle making the airplane fly faster and climb
	Elevator is trimmed for a descent	Trim elevator up slightly
	Propeller is loose or damaged	Land immediately and adjust, repair or replace parts
	Low or no power	Replace or recharge batteries
Aircraft is difficult to launch in the wind	Gusty or cross winds	Launch directly into the wind
	Wind speed is too fast for safe flight	Fly on a calmer day
Flight time is too short	Battery is not fully charged or is damaged	Recharge or replace the battery
	Propeller is loose or damaged	Land immediately and adjust, repair or replace parts
	Flying at full throttle during entire flight	Fly at just above half throttle to increase flying time
	Wind speed is too fast for safe flight	Fly on a calmer day
Aircraft vibrates	Propeller is loose or damaged	Land immediately and adjust, repair or replace parts

Limited Warranty

What this Warranty Covers

Horizon Hobby, LLC, (Horizon) warrants to the original purchaser that the product purchased (the "Product") will be free from defects in materials and workmanship at the date of purchase.

What is Not Covered

This warranty is not transferable and does not cover (i) cosmetic damage, (ii) damage due to acts of God, accident, misuse, abuse, negligence, commercial use, or due to improper use, installation, operation or maintenance, (iii) modification of or to any part of the Product, (iv) attempted service by anyone other than a Horizon Hobby authorized service center, (v) Product not purchased from an authorized Horizon dealer, or (vi) Product not compliant with applicable technical regulations, or (vii) use that violates any applicable laws, rules, or regulations.

OTHER THAN THE EXPRESS WARRANTY ABOVE, HORIZON MAKES NO OTHER WARRANTY OR REPRESENTATION, AND HEREBY DISCLAIMS ANY AND ALL IMPLIED WARRANTIES, INCLUDING, WITHOUT LIMITATION, THE IMPLIED WARRANTIES OF NON-INFRINGEMENT, MERCHANTABILITY AND FITNESS FOR A PARTICULAR PURPOSE. THE PURCHASER ACKNOWLEDGES THAT THEY ALONE HAVE DETERMINED THAT THE PRODUCT WILL SUITABLY MEET THE REQUIREMENTS OF THE PURCHASER'S INTENDED USE.

Purchaser's Remedy

Horizon's sole obligation and purchaser's sole and exclusive remedy shall be that Horizon will, at its option, either (i) service, or (ii) replace, any Product determined by Horizon to be defective.

Horizon reserves the right to inspect any and all Product(s) involved in a warranty claim. Service or replacement decisions are at the sole discretion of Horizon. Proof of purchase is required for all warranty claims. SERVICE OR REPLACEMENT AS PROVIDED UNDER THIS WARRANTY IS THE PURCHASER'S SOLE AND EXCLUSIVE REMEDY.

Limitation of Liability

HORIZON SHALL NOT BE LIABLE FOR SPECIAL, INDIRECT, INCIDENTAL OR CONSEQUENTIAL DAMAGES, LOSS OF PROFITS OR PRODUCTION OR COMMERCIAL LOSS IN ANY WAY, REGARDLESS OF WHETHER SUCH CLAIM IS BASED IN CONTRACT, WARRANTY, TORT, NEGLIGENCE, STRICT LIABILITY OR ANY OTHER THEORY OF LIABILITY, EVEN IF HORIZON HAS BEEN ADVISED OF THE POSSIBILITY OF SUCH DAMAGES. Further, in no event shall the liability of Horizon exceed the individual price of the Product on which liability is asserted. As Horizon has no control over use, setup, final assembly, modification or misuse, no liability shall be assumed nor accepted for any resulting damage or injury. By the act of use, setup or assembly, the user accepts all resulting liability. If you as the purchaser or user are not prepared to accept the liability associated with the use of the Product, purchaser is advised to return the Product immediately in new and unused condition to the place of purchase.

Law

These terms are governed by Illinois law (without regard to conflict of law principals). This warranty gives you specific legal rights, and you may also have other rights which vary from state to state. Horizon reserves the right to change or modify this warranty at any time without notice.

WARRANTY SERVICES

Questions, Assistance, and Services

Your local hobby store and/or place of purchase cannot provide warranty support or service. Once assembly, setup or use of the Product has been started, you must contact your local distributor or Horizon directly. This will enable Horizon to better answer your questions and service you in

the event that you may need any assistance. For questions or assistance, please visit our website at www.horizonhobby.com, submit a Product Support Inquiry, or call the toll free telephone number referenced in the Warranty and Service Contact Information section to speak with a Product Support representative.

Inspection or Services

If this Product needs to be inspected or serviced and is compliant in the country you live and use the Product in, please use the Horizon Online Service Request submission process found on our website or call Horizon to obtain a Return Merchandise Authorization (RMA) number. Pack the Product securely using a shipping carton. Please note that original boxes may be included, but are not designed to withstand the rigors of shipping without additional protection. Ship via a carrier that provides tracking and insurance for lost or damaged parcels, as Horizon is not responsible for merchandise until it arrives and is accepted at our facility. An Online Service Request is available at http://www.horizonhobby.com/content/_service-center_render-service-center. If you do not have internet access, please contact Horizon Product Support to obtain a RMA number along with instructions for submitting your product for service. When calling Horizon, you will be asked to provide your complete name, street address, email address and phone number where you can be reached during business hours. When sending product into Horizon, please include your RMA number, a list of the included items, and a brief summary of the problem. A copy of your original sales receipt must be included for warranty consideration. Be sure your name, address, and RMA number are clearly written on the outside of the shipping carton.

NOTICE: Do not ship LiPo batteries to Horizon. If you have any issue with a LiPo battery, please contact the appropriate Horizon Product Support office.

Warranty Requirements

For Warranty consideration, you must include your original sales receipt verifying the proof-of-purchase date. Provided warranty conditions have been met, your Product will be serviced or replaced free of charge. Service or replacement decisions are at the sole discretion of Horizon.

Non-Warranty Service

Should your service not be covered by warranty, service will be completed and payment will be required without notification or estimate of the expense unless the expense exceeds 50% of the retail purchase cost. By submitting the item for service you are agreeing to payment of the service without notification. Service estimates are available upon request. You must include this request with your item submitted for service. Non-warranty service estimates will be billed a minimum of ½ hour of labor. In addition you will be billed for return freight. Horizon accepts money orders and cashier's checks, as well as Visa, MasterCard, American Express, and Discover cards. By submitting any item to Horizon for service, you are agreeing to Horizon's Terms and Conditions found on our website http://www.horizonhobby.com/content/_service-center_render-service-center.

ATTENTION: Horizon service is limited to Product compliant in the country of use and ownership. If received, a non-compliant Product will not be serviced. Further, the sender will be responsible for arranging return shipment of the un-serviced Product, through a carrier of the sender's choice and at the sender's expense. Horizon will hold non-compliant Product for a period of 60 days from notification, after which it will be discarded.

Warranty and Service Contact Information

Country of Purchase	Horizon Hobby	Phone Number/Email Address	Address
United States of America	Horizon Service Center (Repairs and Repair Requests)	servicecenter.horizonhobby.com/RequestForm/	4105 Fieldstone Rd Champaign, Illinois, 61822 USA
	Horizon Product Support (Product Technical Assistance)	productsupport@horizon-hobby.com 877-504-0233	
	Sales	websales@horizonhobby.com 800-338-4639	
EU	Horizon Technischer Service Sales: Horizon Hobby GmbH	service@horizonhobby.eu +49 (0) 4121 2655 100	Hanskampring 9 D 22885 Barsbüttel, Germany

IC Information

IC: 6157A-RVOF1200

Under Industry Canada regulations, this radio transmitter may only operate using an antenna of a type and maximum (or lesser) gain approved for the transmitter by Industry Canada. To reduce potential radio interference to other users, the antenna type and its gain should be so chosen that the equivalent isotropically radiated power (e.i.r.p.) is not more than that necessary for successful communication.

This device complies with Industry Canada licence-exempt RSS standard(s). Operation is subject to the following two conditions: (1) this device may not cause interference, and (2) this device must accept any interference, including interference that may cause undesired operation of the device."

FCC Information

FCC: BRWRVOF1200

This equipment has been tested and found to comply with the limits for Part 15 of the FCC rules. These limits are designed to provide reasonable protection against harmful interference in a residential installation. This equipment generates uses and can radiate radio frequency energy and, if not installed and used in accordance with the instructions, may cause harmful interference to radio communications.

However, there is no guarantee that interference will not occur in a particular installation. If this equipment does cause harmful interference to radio or television reception, which can be determined by turning the equipment off and on, the user is encouraged to try to correct the interference by one or more of the following measures:

- Reorient or relocate the receiving antenna.
- Increase the separation between the equipment and receiver.
- Connect the equipment to an outlet on a circuit different from that to which the receiver is connected.

This device complies with part 15 of the FCC rules. Operation is subject to the following two conditions: (1) This device may not cause harmful interference, and (2) this device must accept any interference received, including interference that may cause undesired operation

CAUTION: Changes or modifications not expressly approved by the party responsible for compliance could void the user's authority to operate the equipment.

Compliance Information for the European Union

CE **EU Compliance Statement:** Horizon Hobby, LLC hereby declares that this product is in compliance with the essential requirements and other relevant provisions of the RED Directive.

A copy of the EU Declaration of Conformity is available online at: <http://www.horizonhobby.com/content/support-render-compliance>.



Instructions for disposal of WEEE by users in the European Union

This product must not be disposed of with other waste. Instead, it is the user's responsibility to dispose of their waste equipment by handing it over to a designated collections point for the recycling of waste electrical and electronic equipment. The separate collection and recycling of your waste equipment at the time of disposal will help to conserve natural resources and ensure that it is recycled in a manner that protects human health and the environment. For more information about where you can drop off your waste equipment for recycling, please contact your local city office, your household waste disposal service or where you purchased the product.



E328

Replacement Parts • Pièces de rechange

Part # • Nummer Numéro • Codice	Description	Description
RVOF1200	ASCENT SINGLE PUSHER X RTF	ASCENT SINGLE PUSHER RTF
RVOF1201	FUSELAGE: ASCENT SPX	FUSELAGE : ASCENT SPX
RVOF1202	WING: ASCENT SPX	AILE : ASCENT SPX
RVOF1203	HORIZONTAL STAB: ASCENT SPX	STABILISATEUR HORIZONTAL : ASCENT SPX
RVOF1204	PROP W/SPINNER: ASCENT SPX	HÉLICE AVEC CÔNE : ASCENT SPX
RVOF1205	DECAL SHEET: ASCENT SPX	AUTOCOLLANT : ASCENT SPX
RVOF1206	PUSHRODS W/HARDWARE: ASCENT SPX	BARRES DE LIAISON AVEC ACCESSOIRES : ASCENT SPX
RVOF1207	7.4V 850MAH LI-ION BATTERY: ASPX	7,4 V 850 MAH BATTERIE LI-ION : ASPX
RVOF1208	USB CHARGER 2 CELL LI-ION: ASPX	CHARGEUR USB 2 CELLULES LI-ION : ASPX
RVOF1209	RECEIVER/ESC: ASCENT SPX	RÉCEPTEUR/VARIATEUR ESC : ASCENT SPX
RVOF1210	5-WIRE 9G SERVO: ASCENT SPX	5 FILS 9G SERVO : ASCENT SPX
RVOF1211	TRANSMITTER: ASCENT SPX	ÉMETTEUR : ASCENT SPX

Optional Parts • Pièces en option

Part # • Nummer Numéro • Codice	Description	Description
RVOF1212	Aileron Wing w/servo: Ascent SPx	Aileron avec servo : Ascent SPx
RVOF1213	Balance Charger adapter: Ascent SPx	Adaptateur de chargeur : Ascent SPx



REVOLUTION®

RVOF1200

© 2017 Horizon Hobby, LLC.

Revolution, the Revolution logo, and Ascent are trademarks or registered trademarks of Horizon Hobby, LLC.

Updated 10/17

55179.1