

Name: Frank Root

Date: July 2019 Event: Carpet Classic 2019



City: El Centro State: CA

Track: Ricochet RC Raceway

Track Dirt Carpet Tight Smooth Hard Packed Dry Grip Level: Low Medium High
Conditions: Clay Astro Turf Open Rough Loamy Wet Tread Level: Pin Ghost Pin Slicks

Front Suspension

Toe: +/- 0 deg Camber: -2 deg
Ride Height: 15mm Caster Block: 0° 5°
Kick Shim(s): 2mm 1mm Wedge(20°) Other: Brass
VLA Setting: Short Arm Long Arm
Front Pivot: Alum Composite Brass
Pivot Height: SLRC LRC MRC HRC
Piston: 2 x 1.7 thin, TLR333016 Oil: 37.5wt
Limiters: Internal: - External: 1mm Stroke: 23.5
Shock Eyelet: Std. +2 Shock Location: 2 - Middle
Spring: AE V2 Red 91835 Sway Bar: 1.2mm
Spindle Steering Arm: 4 5 6
Spindle Ball Stud: Standard Low Spacers: -
Draglink Ball Stud: Standard Low Spacers: -
Axle Spacing: 0 +.5mm +1mm
Trail: 2mm 3mm 4mm
Camber Link, Inner: 1 2 3 Outer: A B
Tower: Stiffezel Carbon Carbon +2mm
Mud Guard: Soft Standard Stiffezel
Front Wheels: Standard Stiffezel
Front Wing: Low High Narrow High Wide

Stiffezel Parts:
 Front Arm Rear Arm
 Chassis Brace/Waterfall

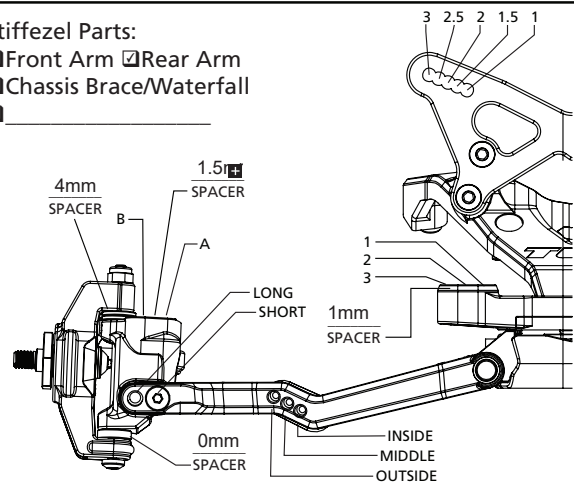

Notes: If running JC or Schumacher fronts, 23mm stroke and 0mm external limiters.

Rear Suspension

Configuration: Laydown Standup
Diff. Height: 0 +1 +1.75 +2.5 +3.5
Axle Height: 0 +1 +2 +3 +4
Ride Height: 16mm Camber: -2 deg
Hub Spacing: 2mm Fr 1mm Rr Hex Width: Standard (5.5)
Piston: 2 x 1.09 thin (TLR333018) Oil: 32.5wt
Spring: AE V2 Gray 91839 Sway Bar: 1.6mm
Limiters: Internal: - External: - Stroke: 30.75mm
Shock Eyelet: Std. +2 Shock Location: 2 - Middle
Shock Mounting: Front Rear Shaft Dia.: 3.0 3.5
Tower: Stiffezel Carbon Carbon +2mm
Camber Block Spacer: 1mm ↓ 0mm 1mm ↑
Camber Link, Inner: 1 2 3
Camber Link, Outer: A B C
Battery Position: 1 2 3 4 5
Wing/Wickerbill: TLR 6.5", 2mm wicker, 2mm off sides
Wing Angle: 0° 2° 4° Wing Height: +4mm (RC Lyfe)
Diff Type: Ball Gear Setting: 10,000cs
Gear Diff Gears: Composite Steel Planet Gears: 2 4
Driveshaft Length: CVA Universal Length: 68mm
CV Pin Position: 1 2 3 4
 Direct Drive Slipper Pads: Torque (yel) Drive (org)

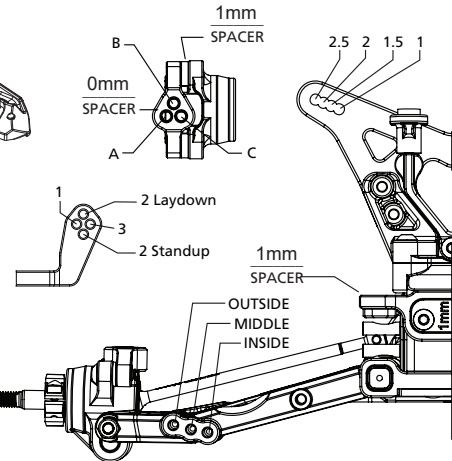
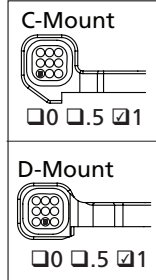
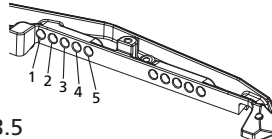
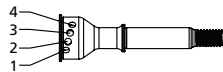

Electronics

Radio: DX6R Timing Advance: 10 Boost
Servo: SPMSS6420RX Steering Expo: -
ESC: HW XR10 Pro Throttle/Brake EPA: 100/85
Motor: Motiv MC2 5.5T
Initial Brake: DB Pinion: 20 Spur: 78
Drag Brake: 8% Battery: Motiv Defy G 4100mAh
Throttle Profile: Battery Weight: 145g

Tires

	Front	Rear
Thread:	PL Prism	PL Prism 2.0
Compound:	Z3	Z3
Insert:	-	Stock
Sauce:	-	-

Notes: Charge to 8.2V
Mounted Brass Electronics Plate 7mm forward.
Prism 2.0 side pins to outside.
Ti screws, ball studs, turnbuckles, shock mounts, and alum nuts to keep weight down.

Chassis

Electronics Plate Brass, 36g Carbon
Battery Plate 19g 26g 37g
Rear Ballast 16g 25g
C-Pivot Block Brass, 20g Aluminum
Total Weight: 1515g
FR: 45.0 % RR: 55.0 %