

Name: Zeke Ballinger

Date: August 2019 Event: Clubbin'



City: Aurora

State: CO

Track: MHOR R/C

Track Dirt Carpet Tight Smooth Hard Packed Dry Grip Level: Low Medium High
 Conditions: Clay Astro Turf Open Rough Loamy Wet Tread Level: Pin Ghost Pin Slicks

Front Suspension

Toe: +/- 0 deg Camber: -1.5 deg
 Ride Height: 20mm Caster Block: 0° 5°
 Kick Shim(s): 2mm 1mm Wedge(20°) Other:
 VLA Setting: Short Arm Long Arm
 Front Pivot: Alum Composite Brass
 Pivot Height: SLRC LRC MRC HRC
 Piston: 3X1.3 + 2X1.0 Oil: 32.5wt
 Limiters: Internal: - External: - Stroke: 23.5mm
 Shock Eyelet: Std. +2 Shock Location: 2 - Middle
 Spring: AE V2 BLUE 91833 Sway Bar: 1.0mm
 Spindle Steering Arm: 4 5 6
 Spindle Ball Stud: Standard Low Spacers: -
 Draglink Ball Stud: Standard Low Spacers: -
 Axle Spacing: 0 +.5mm +1mm
 Trail: 2mm 3mm 4mm
 Camber Link, Inner: 1 2 3 Outer: A B
 Tower: Stiffezel Carbon Carbon +2mm
 Mud Guard: Soft Standard Stiffezel
 Front Wheels: Standard Stiffezel
 Front Wing: Low High Narrow High Wide

Stiffezel Parts:

Front Arm Rear Arm
 Chassis Brace/Waterfall

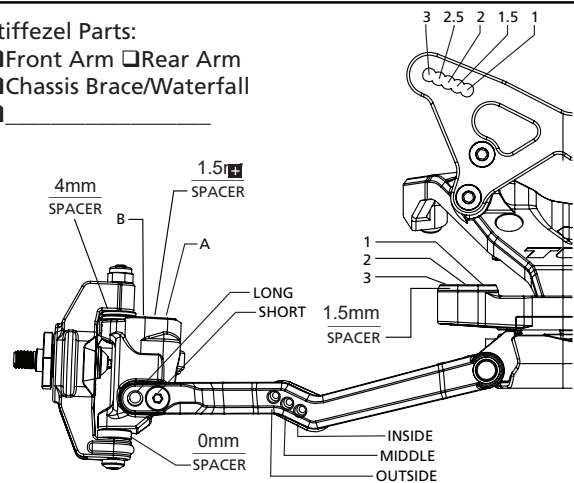

Notes:

Rear Suspension

Configuration: Laydown Standup
 Diff. Height: 0 +1 +1.75 +2.5 +3.5
 Axle Height: 0 +1 +2 +3 +4
 Ride Height: 20mm Camber: -1.5 deg
 Hub Spacing: 1.5mm Fr 1.5mm Rr Hex Width: STD
 Piston: 3X1.4 + 2X1.0 Oil: 30wt
 Spring: AE V2 GREY 91839 Sway Bar: -
 Limiters: Internal: - External: - Stroke: 30.5mm
 Shock Eyelet: Std. +2 Shock Location: 1.5 - Middle
 Shock Mounting: Front Rear Shaft Dia.: 3.0 3.5
 Tower: Stiffezel Carbon Carbon +2mm
 Camber Block Spacer: 1mm ↓ 0mm 1mm ↑
 Camber Link, Inner: 1 2 3
 Camber Link, Outer: A B C
 Battery Position: 1 2 3 4 5
 Wing/Wickerbill: TLR 6.5" Lowest line
 Wing Angle: 0° 2° 4° Wing Height:
 Diff Type: Ball Gear Setting: Tight 3/4 rotation
 Gear Diff Gears: Composite Steel Planet Gears: 2 4
 Driveshaft Length: CVA Universal Length: 67mm
 CV Pin Position: 1 2 3 4
 Direct Drive Slipper Pads: Torque (yel) Drive (org)

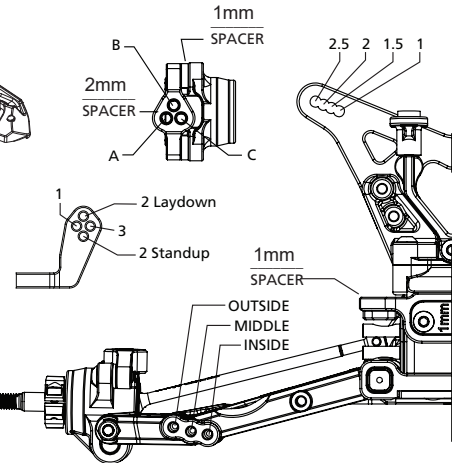
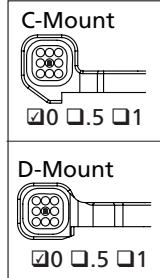
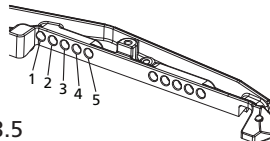

Electronics

Radio: M12 Timing Advance:
 Servo: Spektrum S6240 Steering Expo: -
 ESC: HOBBYWING XR10 Throttle/Brake EPA: 100/87
 Initial Brake: Drag Motor: HOBBYWING V3 7.5T
 Drag Brake: 12% Pinion: 21 Spur: 78
 Throttle Profile: Battery: Protek 5800mAh
 Battery Weight:

Tires

	Front	Rear
Thread:	PL ELECTRON	PL POSITRON
Compound:	MC	MC
Insert:	FULL PL BLUE	PL BLUE
Sauce:	YELLOW LW	YELLOW LW

Notes: Zeke Mod to Rear Foams (sanded v cut)

Chassis

Battery Plate
 19g 26g 37g
 Electronics Plate
 Brass, 36g
 Carbon

 Rear Ballast
 16g 25g
 C-Pivot Block
 Brass, 20g
 Aluminum

Total Weight: 1581
 FR: 42 % RR: 58 %